

2-00-01474  
MILLING STATEMENT APPLICATION FORM



s 9(2)(a) [redacted]

Landowners Name(s): [redacted]

Landowners Address: [redacted]

Phone: [redacted] Fax: [redacted] Email: [redacted]

Applicants Name (if not the Landowner): M & S Swamp Kauri LTD

Applicants Address: 6596 ST HW 1 Victoria Valley Kaitia

s 9(2)(a) [redacted]

Phone: [redacted] Fax: [redacted] Email: s 9(2)(a) [redacted]

Category of timber to be harvested and milled (please circle): (For definitions please refer overleaf)

1 Standing dead 2 Windthrown 3 Salvage 4 Water impoundment 5 Accessway

6 Scientific Research 7 Mining 8 Public Work 9 SILNA 10 Planted indigenous forest

11 Tree Ferns 12 Seized Timber 13 Crown land e.g. Conservation land

Volume estimates:

Species	No. of trees/logs	Volume (m³)	Category (circle as above)
Swamp Kauri	500	1200	3
s 9(2)(a) [redacted]	[redacted]	[redacted]	[redacted]
[redacted]	[redacted]	[redacted]	[redacted]
[redacted]	[redacted]	[redacted]	[redacted]
[redacted]	[redacted]	[redacted]	[redacted]

Other relevant details: [redacted]

Landowners Signature: s 9(2)(a) [redacted] Date: 31-8-2011

Applicants' Checklist

- ☒ Copy of current Land Identifier (Certificate of title)
- ☒ Photographs of trees/logs
- ☒ Map showing property location
- ☐ Map/Aerial photograph showing tree/log location
- ☒ Authorising letter from landowner (where the applicant is not the landowner)
- ☐ For "Mining Timber" applications, include the front page of Mining Licence or Work Programme

Send this form with attachments to:

Sustainable Programmes, Ministry of Agriculture and Forestry  
PO Box 20280 OR PO Box 1340  
Christchurch 8543 Rotorua 3040



7 October 2011

M & S Swamp Kauri Ltd  
6596 SH1, Victoria Valley, RD  
1 Kaitaia 0481

Dear Sir

### Indigenous Timber Milling Statement

Please find attached an INDIGENOUS TIMBER MILLING STATEMENT, which provides for the milling of indigenous timber;

No. 7-00-01474 1,000.0 m<sup>3</sup> Kauri

The approved volume is log roundwood volume.

This statement does not give a right to access land or a right to the ownership of indigenous timber.

#### Milling of indigenous timber

Sawmills milling indigenous timbers are required to be registered under the Forests Act 1949. The sawmiller should receive a copy of the Milling Statement.

It is your responsibility to ensure that you meet any other regulatory requirements. Before harvesting, you should check with your relevant Regional or District Council for any compliance requirements with Regional and/or District Plans under the Resource Management Act 1991.

Yours faithfully

s 9(2)(a)

Programmes Advisor

Tuesday 30/08/2011

**Letter giving permission for the extraction of swamp kauri  
by M & S Swamp Kauri Ltd**

This letter gives permission for M & S Swamp Kauri Ltd to extract any quantity  
of Swamp Kauri from my property s 9(2)(a)  
s 9(2)(a)

s 9(2)(a)

Name:

s 9(2)(a)

Address:

s 9(2)(a)

Signature: s 9(2)(a)





COMPUTER FREEHOLD REGISTER  
UNDER LAND TRANSFER ACT 1952



Search Copy

s 9(2)(a)

Registrar-General  
of Land

Identifier

s 9(2)(a)

Land Registration District **North Auckland**

Date Issued 01 October 1956

Prior References

NA1038/89

Estate	Fee Simple
Area	17.9149 hectares more or less
Legal Description	s 9(2)(a)

Proprietors

s 9(2)(a)

Interests

s 9(2)(a)



Withheld in full s 9(2)(a)

RELEASED UNDER THE  
OFFICIAL INFORMATION ACT











RELEASED UNDER THE  
OFFICIAL INFORMATION ACT



# INDIGENOUS TIMBER MILLING STATEMENT

**Milling Statement No. 7-00-01704**

Period to which this milling statement applies: 28/11/2012 to 27/12/2012

This statement is issued to: M & S Swamp Kauri Ltd

Address: 6596 SH1, Victoria Valley, RD 1 Kaitara 0481

under Section: 67D(1)(b)(iv)

of the Forests Act 1949 for milling: Salvaged Timber

Timber Species and Volumes:

Species	Number of Trees	Number of Logs	Volume m <sup>3</sup> (Roundwood)
Kauri		31	1.090
		Total Volume	1.090

Landholding (C/T Identifier(s)): s 9(2)(a)

Legal Description: s 9(2)(a)

## General Conditions:

This statement allows the timber described above to be milled by any sawmill registered to mill indigenous timber under section 67D(1) of the Forests Act 1949.

This statement does not confer right title or ownership to the timber described above.

Before any felling or harvesting you should check with your relevant Regional or District Council for any resource consent/compliance requirements for such activity under the relevant Regional and/or District Plan.

## Other Conditions:

For logs transferred from non-indigenous land from the above property, if timber is removed from indigenous land the legality of subsequent milling and export of all timber from the above property is voided/invalidated.

Date of issue: 28/11/2012

Signed:

s 9(2)(a)

Acting pursuant to delegated authority made under section 40 of the Forests Act 1949



28 November 2012

s 9(2)(a)

6596 SH Victoria Valley  
Rt 1  
Kaikara 0481

Dear Sir

#### Indigenous Timber Milling Statement

Please find the attached Indigenous Timber Milling Statement which provides for the milling of indigenous timber.

No. 7-00-01704

1090.0 m<sup>3</sup> Kaun

The approved volume is log roundwood volume.

This statement does not give a right to access the land or a right to the ownership of indigenous timber.

#### Milling of indigenous timber

Sawmills milling indigenous timbers are required to be registered under the Forests Act 1949. The sawmiller should receive a copy of the Milling Statement.

It is your responsibility to ensure that you meet any other regulatory requirements. Before harvesting, you should check with your relevant Regional and/or District Plans under the Resource Management Act 1991.

Yours faithfully,

s 9(2)(a)

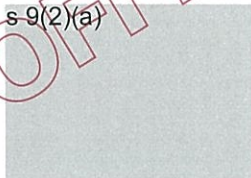



# MILLING STATEMENT APPLICATION FORM



Landowners Name(s): s 9(2)(a)  
 Landowners Address: s 9(2)(a)

Kaitia  
 Phone: s 9(2)(a) Fax: Email:

Applicants Name (if not the Landowner): M. S. Swamp Kauri Ltd  
 Applicants Address: 6596 State Highway 1, RD1, Victoria Valley, Kaitia

Phone: s 9(2)(a) Fax: s 9(2)(a) Email: s 9(2)(a)

Category of timber to be harvested and milled (please circle): (For definitions please refer overleaf)

- |                       |                  |                                      |                     |                              |
|-----------------------|------------------|--------------------------------------|---------------------|------------------------------|
| 1 Standing dead       | 2 Windthrown     | 3 <u>Salvage</u>                     | 4 Water Impoundment | 5 Accessway                  |
| 6 Scientific Research | 7 Mining         | 8 Public Work                        | 9 SILNA             | 10 Planted indigenous forest |
| 11 Tree Ferns         | 12 Seized Timber | 13 Crown land e.g. Conservation land |                     |                              |

Volume estimates:

Species	No. of trees/logs	Volume (m <sup>3</sup> )	Category (circle as above)
Swamp Kauri			1 2 <u>3</u> 4 5 6 7 8 9 10 11 12 13
			1 2 3 4 5 6 7 8 9 10 11
			1 2 3 4 5 6 7 8 9 10 11
			1 2 3 4 5 6 7 8 9 10 11
			1 2 3 4 5 6 7 8 9 10 11

Other relevant details:

s 9(2)(a)  
 Landowners Signature: Date: 19-11-2012

## Applicants' Checklist

- ☒ Copy of current Land Identifier (Certificate of title)
- ☒ Photographs of trees/logs
- ☒ Map showing property location
- ☒ Map/Aerial photograph showing tree/log location
- ☒ Authorising letter from landowner (where the applicant is not the landowner)
- ☐ For "Mining Timber" applications, include the front page of Mining Licence or Work Programme

Send this form with attachments to:

Sustainable Programmes, Ministry of Agriculture and Forestry  
 PO Box 20280 OR PO Box 1340  
 Christchurch 8543 Rotorua 3040

## Terms used in the Forests Act: what they mean

**Owner's personal use:** Timber milled expressly for use by the landowner

**Dead:** Trees (standing or otherwise) that have died as a result of natural causes. There must not be any green foliage on the tree.

**Salvage:** Trees felled to waste before 3 July 1989 or stumps or roots remaining from any trees felled before 3 July 1989. The timber must be taken from an area that is not indigenous forest land

**Windthrown:** Trees that have become windthrown as a result of natural causes.

**Accessway:** Trees removed for establishment or maintenance of a bona fide accessway. Trees felled to enable the construction of a permanent fenceline may be included under this category

**Mining:** Timber removed as a result of a bona fide mining operation



Cell: s 9(2)(a)

Ph/Fax: s 9(2)(a)

E-mail: s 9(2)(a)

M & S Swamp Kauri Ltd

### Fax Transmittal Form

To s 9(2)(a)

Name:

Organization Name/Dept:

CO:

Phone number:

Fax number:

Urgent

For Review

Please Comment

From

M & S Swamp Kauri Ltd

Cell: s 9(2)(a)

Ph/Fax: s 9(2)(a)

E-mail: s 9(2)(a)

Date: 21/11/12

Number of Pages:

### Message:

Hi

s 9(2)(a)

Here is permit application paper  
work & I will email log/stump  
sizes etc.

Thanks

s 9(2)(a)





COMPUTER FREEHOLD REGISTER  
UNDER LAND TRANSFER ACT 1952

Search Copy



s 9(2)(a)

Registrar-General  
of Land

Identifier s 9(2)(a)  
Land Registration District North Auckland  
Date Issued 22 December 1961

Part-Cancelled

Prior References  
NA361/146

Estate Fee Simple  
Area s 9(2)(a)

Legal Description

Proprietors  
s 9(2)(a)

Interests  
s 9(2)(a)

RELEASED UNDER THE  
OFFICIAL INFORMATION ACT

Transaction ID  
Client Reference www.cheapit.co.nz

Search Copy Dated 21/11/12 10:59 am, Page 1 of 2  
Register Only

s 9(2)(a)

RELEASED UNDER THE  
OFFICIAL INFORMATION ACT

Transaction Id  
Client Reference [www.cheaptitles.co.nz](http://www.cheaptitles.co.nz)

Search Copy Dated 21/11/12 10:59 am, Page 2 of 2  
Register Only



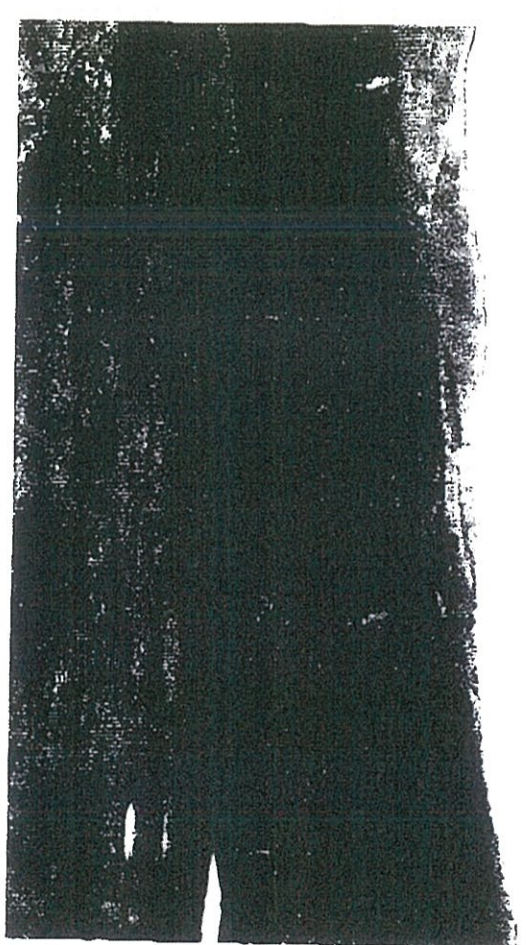
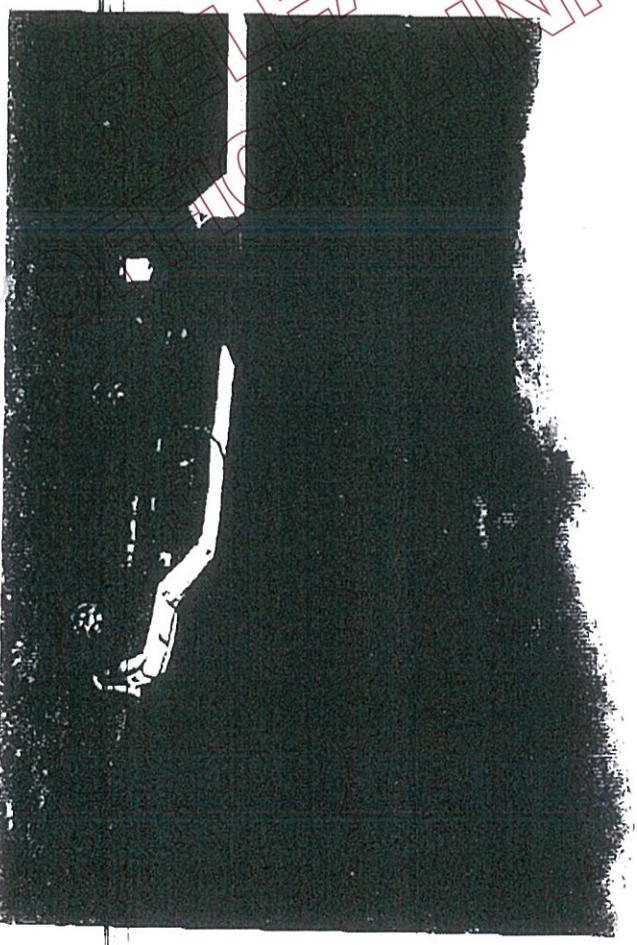
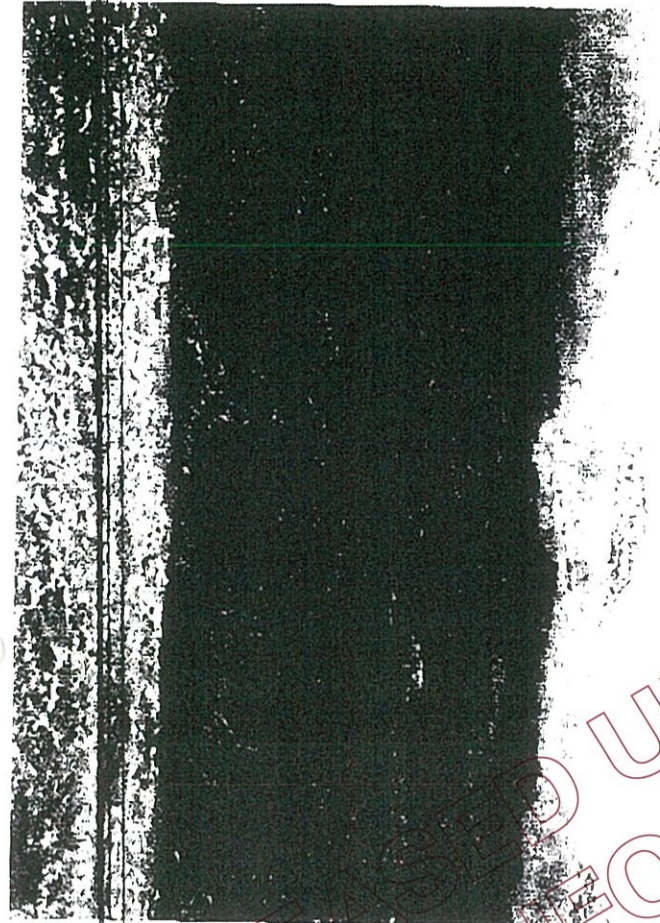



Monday 19<sup>th</sup> November 2012

This is a letter giving permission for M & S Swamp Kauri  
Ltd to extract swamp kauri logs and stumps from my  
property, s 9(2)(a)

Name: s 9(2)(a)

Address: s 9(2)(a)

Date: s 9(2)(a)

Signature

RELEASED UNDER THE  
OFFICIAL INFORMATION ACT

RELEASED UNDER THE  
OFFICIAL INFORMATION ACT



## INDIGENOUS TIMBER MILLING STATEMENT

### Milling Statement No. 7-00-01915

Period to which this milling statement applies: 3/10/2013 to 2/4/2015

This statement is issued to: Swamp Loggers Ltd

Address: 26 Ngungaru Ford Road Whangarei 0173

under Section: 67D(1)(b)(iv)

of the Forests Act 1949 for milling: Salvaged Timber

Timber Species and Volumes:

Species	Number of Trees	Number of Logs	Volume m <sup>3</sup> (Roundwood)
Kauri		24	350.0
Total Volume			350.0

Landholding (C/T Identifier(s)): s 9(2)(a)

Legal Description: s 9(2)(a)

Computer Freehold Register Unique Identifier s 9(2)(a)

#### General Conditions:

- This statement allows the timber listed above to be milled at any sawmill registered to mill indigenous timber under section 67D(1) of the Forests Act 1949.
- This statement does not confer right, title or ownership to the timber described above.
- Before any felling or harvesting you should check with your relevant Regional or District Council for any resource consent/compliance requirements for such activity under the relevant Regional and/or District Plans.

#### Other Conditions:

For swamp kauri excavated from non indigenous land on s 9(2)(a) property

Date of Issue: 3/10/2013

Office Use only ref

Signed:

s 9(2)(a)

Programmes Advisor

Acting pursuant to delegated authority made  
under section 4A of the Forests Act 1949





3 October 2013

Swamp Loggers Ltd  
26 Ngungaru Ford Road  
Whangarei 0173

Dear Sir

### Indigenous Timber Milling Statement

Please find attached an INDIGENOUS TIMBER MILLING STATEMENT, which provides for the milling of indigenous timber;

No. 7-00-01915 350.0 m<sup>3</sup> Kauri

The approved volume is log roundwood volume.

This statement does not give a right to access land or a right to the ownership of indigenous timber.

#### Milling of indigenous timber

Sawmills milling indigenous timbers are required to be registered under the Forests Act 1949. The sawmiller should receive a copy of the Milling Statement.

It is your responsibility to ensure that you meet any other regulatory requirements. Before harvesting, you should check with your relevant Regional or District Council for any compliance requirements with Regional and/or District Plans under the Resource Management Act 1991.

Yours faithfully

s 9(2)(a)

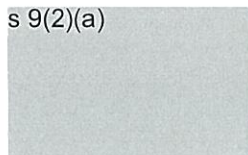

Programmes Advisor



## MILLING STATEMENT APPLICATION FORM

Landowners Name(s): s 9(2)(a)

Landowners Address: s 9(2)(a)

Phone: s 9(2)(a) Fax: Email:

Applicants Name (if not the Landowner):

Applicants Address: Swamp Loggers Ltd  
363 Kokopu Blk Rd RD 9 Whangarei 0179

Phone: s 9(2)(a) Fax: Email: s 9(2)(a)

Category of timber to be harvested and milled (please circle): (For definitions please refer overleaf)

1 Standing dead	2 Windthrown	3 Salvage	4 Water Impoundment	5 Accessway
6 Scientific Research	7 Mining	8 Public Work	9 SILNA	10 Planted indigenous forest
11 Tree Ferns	12 Seized Timber	13 Crown land e.g. Conservation land		

## Volume estimates:

Species	No. of trees/logs	Volume (m <sup>3</sup> )	Category (circle as above)
•			1 2 3 4 5 6 7 8 9 10 11 12 13
•			1 2 3 4 5 6 7 8 9 10 11
•			1 2 3 4 5 6 7 8 9 10 11
•			1 2 3 4 5 6 7 8 9 10 11
•			1 2 3 4 5 6 7 8 9 10 11

Other relevant details:

Landowners Signature: s 9(2)(a) Date: 25.03.2012.

## Applicants' Checklist

- ☐ Copy of current Land Identifier (Certificate of title)
- ☐ Photographs of trees/logs
- ☐ Map showing property location
- ☐ Map/Aerial photograph showing tree/log location
- ☐ Authorising letter from landowner (where the applicant is not the landowner)
- ☐ For "Mining Timber" applications, include the front page of Mining Licence or Work Programme

Send this form with attachments to:

Sustainable Programmes, Ministry of Agriculture and Forestry  
PO Box 20280 OR PO Box 1340  
Christchurch 8543 Rotorua 3040

# Swamp Loggers Limited

**Registered Office:**

363 Kokopu Block Road

R D 9 Whangarei 0179

GST No: 107 484 507

DATE: 25 / 3 / 12
**Re: SWAMP KAURI EXTRACTION AGREEMENT – Application to MAF**

s 9(2)(a)

I (Print Name) \_\_\_\_\_ agree to the extraction of swamp kauri from

(Property Certificate of Title ) \_\_\_\_\_ as per  
s 9(2)(a)

the attached plans and arranged agreement signed with SWAMP LOGGERS LIMITED

s 9(2)(a)

LANDOWNERS SIGNATURE: \_\_\_\_\_

DATE: 25 / 3 / 12

s 9(2)(a)

APPLICANTS SIGNATURE: \_\_\_\_\_

DATE: 28 / 03 / 2012SWAMP LOGGERS LTD  
Phone s 9(2)(a)





COMPUTER FREEHOLD REGISTER  
UNDER LAND TRANSFER ACT 1952



s 9(2)(a)

Registrar-General  
of Land

Search Copy

Identifier

s 9(2)(a)

Land Registration District **North Auckland**

Date Issued 08 April 1975

Prior References

NA10A/813

Estate

Fee Simple

Area

s 9(2)(a)

Legal Description

Proprietors

s 9(2)(a)

Interests

RELEASED UNDER THE  
OFFICIAL INFORMATION ACT

RELEASED UNDER THE  
OFFICIAL INFORMATION ACT



s 9(2)(a)

RELEASED UNDER THE  
OFFICIAL INFORMATION ACT





RELEASED UNDER THE  
OFFICIAL INFORMATION ACT



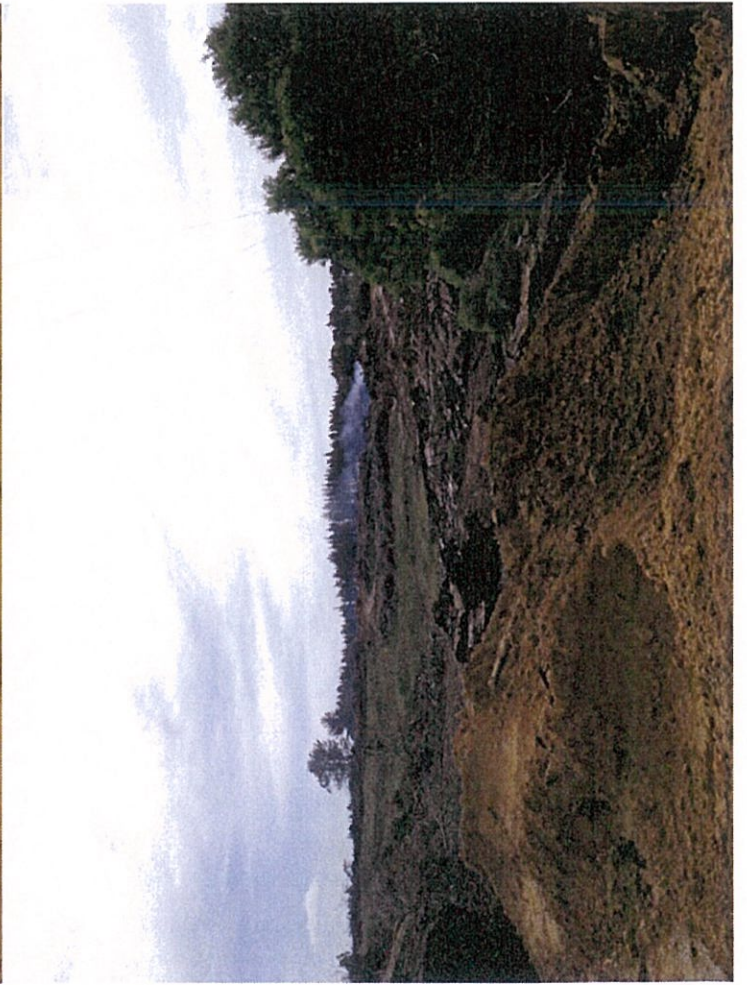



Excavation Area

Drawn For: Swamp Loggers

Subject Site: S 9(2)(a)

Version: 1.0

Date 29/3/12

Drawn By: JMH

Sheet: 1 of 1

Scale: 1:3000 @ A3



KEY

Excavation Area (22.8307ha)



Notes:

Dimensions are approximate.

HEWSON PLANNING  
RESOURCE CONSENT SPECIALISTS

Ph: (09) 43008651 Mob: 0212333669 Email: info@hewsonplanning.co.nz







s 9(2)(a)

## INDIGENOUS TIMBER MILLING STATEMENT

### Milling Statement No. 7-00-01969

Period to which this milling statement applies: 17/1/2014 to 16/7/2016

This statement is issued to: M & S Swamp Kauri Ltd

Address: 6596 SH1, Victoria Valley, RD 1 Kaitaia 0481

under Section: 67D(1)(b)(iv)

of the Forests Act 1949 for milling: Salvaged Timber

Timber Species and Volumes:

Species	Number of Trees	Number of Logs	Volume m <sup>3</sup> (Roundwood)
Kauri			3,000.0
Total Volume			3,000.0

Landholding (C/T Identifier(s)): s 9(2)(a)

Legal Description: s 9(2)(a)

Computer Freehold Register Unique Identifier s 9(2)(a)

#### General Conditions:

- This statement allows the timber listed above to be milled at any sawmill registered to mill indigenous timber under section 67D(1) of the Forests Act 1949.

This statement does not confer right, title or ownership to the timber described above.

Before any felling or harvesting you should check with your relevant Regional or District Council for any resource consent/compliance requirements for such activity under the relevant Regional and/or District Plans.

#### Other Conditions:

- For Swamp kauri from non indigenous land on the Julina farms property

Date of Issue: 17/1/2014

Signed: \_\_\_\_\_

Office Use only ref

s 9(2)(a)

Programmes Advisor

Acting pursuant to delegated authority made  
under section 4A of the Forests Act 1949

17 January 2014

M & S Swamp Kauri Ltd  
6596 SH1, Victoria Valley, RD  
1 Kaitaia 0481

Dear Sir

### Indigenous Timber Milling Statement

Please find attached an INDIGENOUS TIMBER MILLING STATEMENT, which provides for the milling of indigenous timber;

No. 7-00-01969

3,000.0 m<sup>3</sup> Kauri

The approved volume is log roundwood volume.

This statement does not give a right to access land or a right to the ownership of indigenous timber.

#### Milling of indigenous timber

Sawmills milling indigenous timbers are required to be registered under the Forests Act 1949. The sawmiller should receive a copy of the Milling Statement.

It is your responsibility to ensure that you meet any other regulatory requirements. Before harvesting, you should check with your relevant Regional or District Council for any compliance requirements with Regional and/or District Plans under the Resource Management Act 1991.

Yours faithfully

s 9(2)(a)

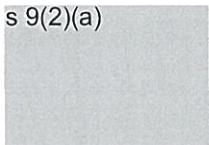

Programmes Advisor





RELEASED UNDER THE  
OFFICIAL INFORMATION ACT





RELEASED UNDER THE  
OFFICIAL INFORMATION ACT









RELEASED UNDER THE  
OFFICIAL INFORMATION ACT



COMPUTER FREEHOLD REGISTER  
UNDER LAND TRANSFER ACT 1952

Search Copy



Identifier s 9(2)(a)  
Land Registration District North Auckland  
Date Issued 07 January 1974

Prior References  
NA20B/1152

Estate Fee Simple  
Area 22.4625 hectares more or less  
Legal Description s 9(2)(a)

Proprietors  
s 9(2)(a)

Interests

RELEASED UNDER THE  
OFFICIAL INFORMATION ACT

Transaction Id 39042137  
Client Reference mrcshana001

Search Copy Date 17/01/14 9:54 am Page 1 of 1  
Register Only

17/01/2014 09:54:25 0001.pdf

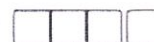
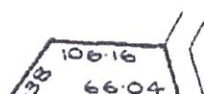

Open with



# MILLING STATEMENT APPLICATION FORM

Ministry for Primary Industries  
Manatū Ahu Matua



Landowners Name(s): AS PER ATTACHED AGREEMENT

Landowners Address: \_\_\_\_\_

Phone: \_\_\_\_\_ Fax: \_\_\_\_\_ Email: \_\_\_\_\_

Applicants Name (if not the Landowner): M & S Subump Kauri LTD

Applicants Address: 6596 State Highway 1 Victoria Valley Kaitia

s 9(2)(a) \_\_\_\_\_ s 9(2)(a) \_\_\_\_\_

Phone: \_\_\_\_\_ Fax: \_\_\_\_\_ Email: \_\_\_\_\_

Category of timber to be harvested and milled (please circle): (For definitions please refer overleaf)

1 Standing dead	2 Windthrown	3 Salvage	4 Water Impoundment	5 Accessway
6 Scientific Research	7 Mining	8 Public Work	9 SILNA	10 Planted indigenous forest
11 Tree Ferns	12 Seized Timber	13 Crown land e.g. Conservation land		

Volume estimates:

Species	No. of trees/logs	Volume (m <sup>3</sup> )	Category (circle as above)
• <u>Subump Kauri</u>	<u>3000</u>	<u>3000</u>	1 2 <u>3</u> 4 5 6 7 8 9 10 11 12 13
• _____	_____	_____	1 2 3 4 5 6 7 8 9 10 11
• _____	_____	_____	1 2 3 4 5 6 7 8 9 10 11
• _____	_____	_____	1 2 3 4 5 6 7 8 9 10 11
• _____	_____	_____	1 2 3 4 5 6 7 8 9 10 11

Other relevant details: \_\_\_\_\_

s 9(2)(a) \_\_\_\_\_

Landowners Signature: \_\_\_\_\_ Date: 17/01/2014

## Applicants' Checklist

- ☒ Copy of current Land Identifier (Certificate of title)
- ☒ Photographs of trees/logs
- ☒ Map showing property location
- ☒ Map/Aerial photograph showing tree/log location
- ☒ Authorising letter from landowner (where the applicant is not the landowner)
- ☒ For "Mining Timber" applications, include the front page of Mining Licence or Work Programme

Send this form with attachments to:

Forestry and Land Operations, Ministry for Primary Industries  
Private Bag 4765 OR PO Box 1340  
Christchurch 8140 Rotorua 3040



RELEASED UNDER THE  
OFFICIAL INFORMATION ACT

## Contract for extraction of Swamp Kauri.

M & S Swamp Kauri Ltd  
s 9(2)(a)

This Contract is entered into by and between M & S Swamp Kauri Ltd and s 9(2)(a). The term of this Agreement shall begin on open time frame and shall continue through to its termination when all Kauri logs are extracted and removed from site with the land put back to the agreed standard.

The specific terms of this Contract are as follows:

s 9(2)(a), s 9(2)(b)(ii)



s 9(2)(a), s 9(2)(b)(ii)

RELEASED UNDER THE  
OFFICIAL INFORMATION ACT

RELEASED UNDER THE  
OFFICIAL INFORMATION ACT





## INDIGENOUS TIMBER MILLING STATEMENT

### Milling Statement No. 7-00-02155

Period to which this milling statement applies: 24/9/2014 to 23/3/2016

This statement is issued to: M & S Swamp Kauri Ltd

Address: 6596 SH1, Victoria Valley, RD 1 Kaitia 0481

under Section: 67D(1)(b)(iv)

of the Forests Act 1949 for milling: Salvaged Timber

Timber Species and Volumes:

Species	Number of Trees	Number of Logs	Volume m <sup>3</sup> (Roundwood)
Kauri		3	75.0
Total Volume			75.0

Landholding (C/T Identifier(s)): s 9(2)(a)

Legal Description: s 9(2)(a)

Computer Freehold Register Unique Identifier s 9(2)(a)

#### General Conditions:

- This statement allows the timber listed above to be milled at any sawmill registered to mill indigenous timber under section 67D(1) of the Forests Act 1949.
- This statement does not confer right, title or ownership to the timber described above.
- Before any felling or harvesting you should check with your relevant Regional or District Council for any resource consent/compliance requirements for such activity under the relevant Regional and/or District Plans.

#### Other Conditions:

- This milling statement allows the milling of salvaged swamp kauri excavated from non indigenous land on the property listed above belonging to s 9(2)(a). A map prepared by the Ministry for Primary Industries (MPI) for the applicant identified areas of non indigenous land denoted as "Approved timber source area". This milling statement applies to that area. (MPI map to accompany milling statement) If timber is removed outside those areas, it is up to the applicant to provide further evidence in order to satisfy the secretary that it has been removed from non indigenous land before it is milled. Failure to do so may jeopardise the legality of subsequent sales and exports of any timber removed from s 9(2)(a) property.

Date of Issue: 24/9/2014

Signed:

s 9(2)(a)

Office Use only ref

Programmes Advisor

Acting pursuant to delegated authority made  
under section 4A of the Forests Act 1949





24 September 2014

M & S Swamp Kauri Ltd  
6596 SH1, Victoria Valley, RD  
1 Kaitaia 0481

Dear Sir

### Indigenous Timber Milling Statement

Please find attached an INDIGENOUS TIMBER MILLING STATEMENT, which provides for the milling of indigenous timber;

No. 7-00-02155      75.0 m<sup>3</sup> Kauri

The approved volume is log roundwood volume.

This statement does not give a right to access land or a right to the ownership of indigenous timber.

### Milling of indigenous timber

Sawmills milling indigenous timbers are required to be registered under the Forests Act 1949. The sawmiller should receive a copy of the Milling Statement.

It is your responsibility to ensure that you meet any other regulatory requirements. Before harvesting, you should check with your relevant Regional or District Council for any compliance requirements with Regional and/or District Plans under the Resource Management Act 1991.

Yours faithfully

s 9(2)(a)

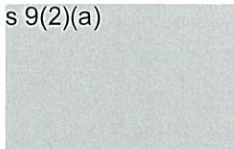

Programmes Advisor







40 20 0 40 Meters



Ministry for Primary Industries  
Manatū Ahu Matua



### Legend

-  Approved\_timber\_source\_area
-  nz\_all\_parcel





Swamp Kauri Ltd

s 9(2)(a)

s 9(2)(a)

M & S Swamp Kauri Ltd  
6596 State Highway 1  
RD1  
Victoria Valley  
Kaitia  
s 9(2)(a)

This contract is entered into by and between M & S Swamp Kauri Ltd and s 9(2)(a). The term of this agreement shall begin on the signing of this document.

The specific terms of this Contract are as follows:

s 9(2)(a), s 9(2)(b)(ii)

RELEASED UNDER THE  
OFFICIAL INFORMATION ACT



**MS**

**Swamp Kauri Ltd**

s 9(2)(a)

s 9(2)(a)

s 9(2)(a), s 9(2)(b)(ii)

RELEASED UNDER THE  
OFFICIAL INFORMATION ACT





COMPUTER FREEHOLD REGISTER  
UNDER LAND TRANSFER ACT 1952



s 9(2)(a)

Registrar-General  
of Land

Search Copy

Identifier s 9(2)(a)  
Land Registration District **North Auckland**  
Date Issued 24 May 1990

Prior References

NA1150/56 NA470/276

Estate Fee Simple  
Area 33.0339 hectares more or less  
Legal Description s 9(2)(a)

Proprietors

s 9(2)(a)

Estate Fee Simple - 1/2 share  
Area 9601 square metres more or less  
Legal Description s 9(2)(a)

Proprietors

s 9(2)(a)

Interests

s 9(2)(a)





9 July 2015

M & S Swamp Kauri Ltd  
6596 SH1, Victoria Valley, RD  
1 Kaitaia 0481

Dear Sir

### Indigenous Timber Milling Statement

Please find attached an INDIGENOUS TIMBER MILLING STATEMENT, which provides for the milling of indigenous timber.

No. 7-00-02342 405.5 m<sup>3</sup> Kauri

The approved volume is log roundwood volume.

This statement does not give a right to access land or a right to the ownership of indigenous timber.

#### Milling of indigenous timber

Sawmills milling indigenous timbers are required to be registered under the Forests Act 1949. The sawmiller should receive a copy of the Milling Statement.

It is your responsibility to ensure that you meet any other regulatory requirements. Before harvesting, you should check with your relevant Regional or District Council for any compliance requirements with Regional and/or District Plans under the Resource Management Act 1991.

Yours faithfully  
s 9(2)(a)

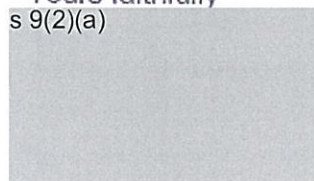

Programmes Advisor



# INDIGENOUS TIMBER MILLING STATEMENT

## Milling Statement No. 7-00-02342

Period to which this milling statement applies: 30/7/2015 to 29/1/2016

This statement is issued to: M & S Swamp Kauri Ltd

Address: 6596 SH1, Victoria Valley, RD 1 Kaitaia 0481

under Section: 67D(1)(b)(iv)

of the Forests Act 1949 for milling: Salvaged Timber

Timber Species and Volumes:

Species	Number of Trees	Number of Logs	Volume m <sup>3</sup> (Roundwood)
Kauri			405.5
Total Volume			405.5

Landholding (C/T Identifier(s)): s 9(2)(a)

Legal Description: s 9(2)(a)

Computer Freehold Register Unique Identifier s 9(2)(a)

### General Conditions:

- This statement allows the timber listed above to be milled at any sawmill registered to mill indigenous timber under section 67D(1) of the Forests Act 1949.
- This statement does not confer right, title or ownership to the timber described above.
- Before any felling or harvesting you should check with your relevant Regional or District Council for any resource consent/compliance requirements for such activity under the relevant Regional and/or District Plans.

### Other Conditions:

- For logs extracted from non-indigenous land from the above property. If timber is removed from indigenous land the legality of subsequent milling and export of all timber from the above property may be jeopardised

Date of Issue: 30/7/2015

Signed:

s 9(2)(a)

Office Use only ref

Acting pursuant to delegated authority.





Milling Statement Decision Recommendation	
<b>Milling Statement Reference No.</b>	7-00-02342
<b>Applicant</b>	M & S Swamp Kauri Ltd
<b>Date Received</b>	9/07/2015
<b>Forests Act 1949 Part 3A Section 67D</b>	<p>(b) the Secretary has stated in writing that he or she is satisfied that—</p> <p>(iv) the timber is salvaged timber that has been or will be harvested from an area of land that is not indigenous forest land</p>
<b>Applicant has Authority to Apply</b>	The applicant has supplied a signed note from the landowner giving them permission to extract logs and stumps from their property. I am satisfied the applicant has the authority to apply.
<b>Application Evidence</b>	<p>The applicant has provided a signed note from the landowner, photographs of the extraction, and a copy of the land title.</p> <p>A new land title was sourced from landowner s 9(2)(a) provided some photographs of the site that were taken by himself.</p>
<b>Site Inspection Undertaken</b>	<p> Extraction Site inspections.docx</p> <p>Site inspection conducted on 24/07/2015 by s 9(2)(a) s 9(2)(a)</p> <p>This site has previously had timber extracted under milling statement 7-00-01704. The historical activity has resulted in the soil becoming more waterlogged than previously, and some indigenous grasses have established. However ryegrass and buffalo grass are by far the dominant vegetation.</p> <p>The timber is being removed as it is extracted and could not be inspected. However a detailed inventory has been provided which will be able to be checked when forestry officers conduct sawmill inspections.</p> <p>Based on this inspection I am satisfied the timber being has been harvested from an area of land that is not indigenous forest land.</p>
<b>Recommendation</b>	<p>A milling statement (number 7-00-01704) was previously approved for swamp kauri coming from this property. During the operations the applicant extracted more swamp kauri than originally expected.</p> <p>A site inspection was previously done by s 9(2)(a) who can confirm that the timber being extracted was swamp kauri, and that it was not being extracted from indigenous forest land. The dominant vegetation pre-extraction was gorse.</p> <p>An additional inspection was done on 24/07/2015 (see above).</p>



s 9(2)(a) filenote

**Swamp Kauri Extraction Sites.**

On 24/07/2015 MPI Forestry Officers s 9(2)(a) inspected two sites from which swamp kauri had been extracted.

These inspections were done as part of the Milling Statement approval process, in order to establish that the timber being applied for has been harvested from an area of land that is not indigenous forest land (Section 67D(1)(b)(iv) of the Forests Act 1949). The results of these inspections are detailed below.

**7-00-02337** s 9(2)(a)

The s 9(2)(a) property had been rehabilitated before the inspection. The extraction site was consistent with the aerial photographs included with the application (previously deer paddocks). There was no indigenous vegetation present in the paddock, or amongst the stacked vegetation (from the removed shelter belts). The landowner noted that the drainage of the paddock had been affected by extraction and was now significantly more waterlogged.

The extracted timber has been removed (except for three stumps), and could not be inspected. However a detailed inventory has been provided which will be able to be checked when forestry officers conduct sawmill inspections.

Based on this inspection I am satisfied the timber being has been harvested from an area of land that is not indigenous forest land.





**7-00-02342 (M&S Swamp Kauri Ltd)**

This site has previously had timber extracted under milling statement 7-00-01704. The historical activity has resulted in the soil becoming more waterlogged than previously, and some indigenous grasses have established. However ryegrass and buffalo grass are by far the dominant vegetation.

The timber is being removed as it is extracted and could not be inspected. However a detailed inventory has been provided which will be able to be checked when forestry officers conduct sawmill inspections.

Based on this inspection I am satisfied the timber being has been harvested from an area of land that is not indigenous forest land.





# MILLING STATEMENT APPLICATION FORM



Landowners Name(s): s 9(2)(a)  
 Landowners Address:   
 Phone: s 9(2)(a) Fax: Email: s 9(2)(a)  
 Applicants Name (if not the Landowner): s 9(2)(a)  
 Applicants Address: 6596 SH1 RDI Victoria Valley  
 Kaitaia  
 Phone: s 9(2)(a) Fax: Email: s 9(2)(a)

Category of timber to be harvested and milled (please circle): (For definitions please refer overleaf)

1 Standing dead	2 Windthrown	3 <u>Salvage</u>	4 Water Impoundment	5 Accessway
6 Scientific Research	7 Mining	8 Public Work	9 SILNA	10 Planted indigenous forest
11 Tree Ferns	12 Seized Timber	13 Crown land e.g. Conservation land		

Volume estimates:

Species	No. of trees/logs	Volume (m <sup>3</sup> )	Category (circle as above)
Swamp Kauri		405.5m <sup>3</sup>	1 2 3 4 5 6 7 8 9 10 11 12 13
(Agathis Australis)			1 2 3 4 5 6 7 8 9 10 11
			1 2 3 4 5 6 7 8 9 10 11
			1 2 3 4 5 6 7 8 9 10 11
			1 2 3 4 5 6 7 8 9 10 11

Other relevant details:   
 Landowners Signature: Date: 3/7/15

## Applicants' Checklist

- ☒ Copy of current Land Identifier (Certificate of title)
- ☒ Photographs of trees/logs
- ☒ Map showing property location
- ☒ Map/Aerial photograph showing tree/log location
- ☒ Authorising letter from landowner (where the applicant is not the landowner)
- ☐ For "Mining Timber" applications, include the front page of Mining Licence or Work Programme

Send this form with attachments to:

Sustainable Programmes, Ministry of Agriculture and Forestry  
 PO Box 20280 OR PO Box 1340  
 Christchurch 8543 Rotorua 3040



# MILLING STATEMENT APPLICATION FORM



Landowners Name(s): s 9(2)(a)  
 Landowners Address: s 9(2)(a)  
 Phone: s 9(2)(a) Fax: Email:  
 Applicants Name (if not the Landowner): M. S. Swamp Kauri Ltd  
 Applicants Address: 6596 State Highway 1, RD1, Victoria Valley, Kaitiaki  
 Phone: s 9(2)(a) Fax: s 9(2)(a) Email: s 9(2)(a)

Category of timber to be harvested and milled (please circle): (For definitions please refer overleaf)

1 Standing dead	2 Windthrown	3 Salvage	4 Water Impoundment	5 Accessway
6 Scientific Research	7 Mining	8 Public Work	9 SILNA	10 Planted indigenous forest
11 Tree Ferns	12 Seized Timber	13 Crown land e.g. Conservation land		

Volume estimates:

Species	No. of trees/logs	Volume (m³)	Category (circle as above)
Swamp Kauri			1 2 3 4 5 6 7 8 9 10 11 12 13
			1 2 3 4 5 6 7 8 9 10 11
			1 2 3 4 5 6 7 8 9 10 11
			1 2 3 4 5 6 7 8 9 10 11
			1 2 3 4 5 6 7 8 9 10 11

Other relevant details: s 9(2)(a)  
 Landowners Signature: s 9(2)(a) Date: 19-11-2012

## Applicants' Checklist

- ☒ Copy of current Land Identifier (Certificate of title)
- ☒ Photographs of trees/logs
- ☒ Map showing property location
- ☒ Map/Aerial photograph showing tree/log location
- ☒ Authorising letter from landowner (where the applicant is not the landowner)
- ☐ For "Mining Timber" applications, include the front page of Mining Licence or Work Programme

Send this form with attachments to:

Sustainable Programmes, Ministry of Agriculture and Forestry  
 PO Box 20280 OR PO Box 1340  
 Christchurch 8543 Rotorua 3040

Monday 19<sup>th</sup> November 2012

This is a letter giving permission for M & S Swamp Kauri Ltd to extract swamp kauri logs and stumps from my property, s 9(2)(a)

Name: s 9(2)(a)

Address: s 9(2)(a)

Date: 20/11/12  
s 9(2)(a)

Signature: s 9(2)(a)

RELEASED UNDER THE  
OFFICIAL INFORMATION ACT





COMPUTER FREEHOLD REGISTER  
UNDER LAND TRANSFER ACT 1952



Search Copy

Registrar-General  
of Land

Identifier s 9(2)(a)  
Land Registration District North Auckland  
Date Issued 22 December 1961

Part-Cancelled

Prior References  
NA361/146

Estate Fee Simple  
Area 181.6027 hectares more or less  
Legal Description s 9(2)(a)

Proprietors  
s 9(2)(a)

Interests  
s 9(2)(a)

s 9(2)(a)

s 9(2)(a)

RELEASED UNDER THE  
OFFICIAL INFORMATION ACT



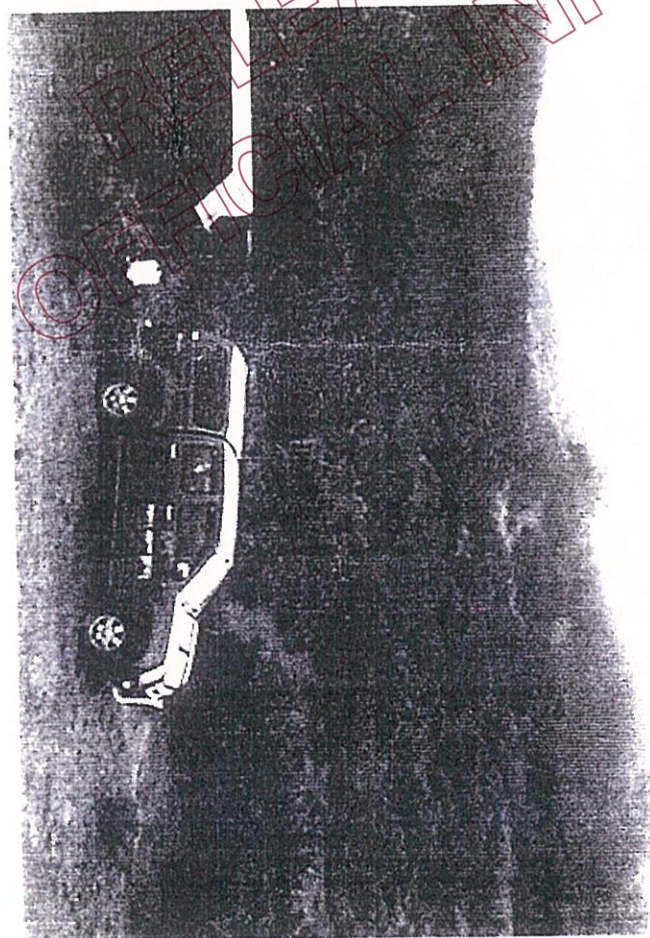



RELEASED UNDER THE  
OFFICIAL INFORMATION ACT

Extraction  
Area



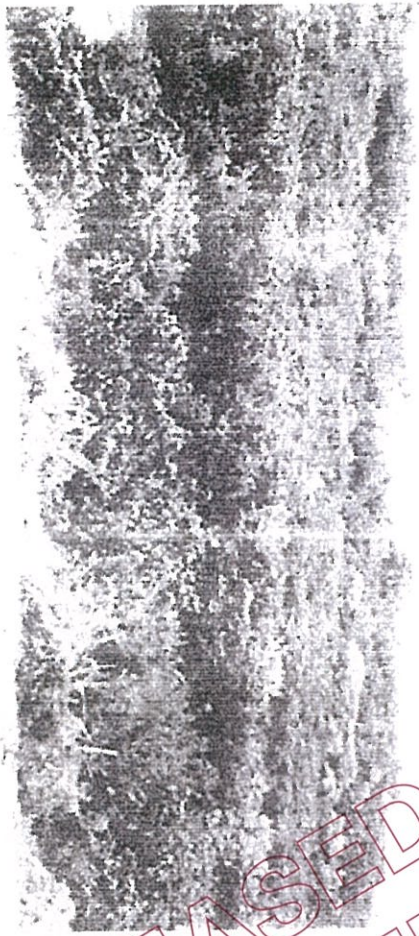

RELEASED UNDER THE  
OFFICIAL INFORMATION ACT



RELEASED UNDER THE  
OFFICIAL INFORMATION ACT

s 9(2)(a)





RELEASED UNDER  
OFFICIAL INFORMATION ACT





RELEASED UNDER  
OFFICIAL INFORMATION ACT







COMPUTER FREEHOLD REGISTER  
UNDER LAND TRANSFER ACT 1952



Registrar-General  
of Land

Search Copy

Identifier s 9(2)(a)  
Land Registration District **North Auckland**  
Date Issued 22 December 1961

Part-Cancelled

Prior References  
NA361/146

Estate Fee Simple  
Area 181.6027 hectares more or less  
Legal Description s 9(2)(a)

Proprietors  
s 9(2)(a)

Interests  
s 9(2)(a)

s 9(2)(a)

RELEASED UNDER THE  
OFFICIAL INFORMATION ACT

K1	0.9	0.65	2.7		1.1	1.15	S log
	0.15	0.4595		0.9936	0.32	1.9616	
4	1.0	1.2	2.0	2.1	1.6	3.5815	S
	0.30	0.9425		2.6390	0.84		
K3	2.8	1.6	2.2	2.8	1.6	7.7411	S
	1.12	3.5167		3.5167	1.12		
K4	2.2	1.1	3.1	2.2	1.1	5.0523	S
	0.61	1.5067		1.5067	0.61		
K5	2.0	2.0	1.1	2.0	2.0	3.4559	S
	1.00	3.1417		3.1417	1.00		
K6	0.6	0.8	2.5	1.8	2.2	4.3591	S log
	0.12	0.3770		3.1103	0.99		
K7	2.1	1.25	2.3	2.1	1.25	4.7420	S
	0.66	2.0617		2.0617	0.66		
K8	1.7	1.3	2.8	1.7	1.3	4.8602	S
	0.55	1.7358		1.7358	0.55		
K9	2.3	1.9	1.9	2.3	1.9	6.5214	S
	1.09	3.4323		3.4323	1.09		
K10	4.2	2.5	3.0	4.2	2.5	24.7408	S
	2.63	6.2470		6.2470	2.63		
K11	2.6	1.4	3.0	2.9	4.6	20.0048	S log
	0.91	2.6569		10.4776	3.34		
K12	3.0	1.8	2.1	3.0	1.8	8.9067	S
	1.35	4.2413		4.2413	1.35		
K13	2.9	2.2	1.6	2.7	2.2	7.7411	S
	1.60	5.0110		4.6654	1.49		
K14	1.9	0.8	2.1	1.9	1.5	3.6039	S
	0.38	1.1938		2.2385	0.71		
K15	1.050	0.95	2.2	1	0.9	1.6394	S
	0.25	0.7835		0.7069	0.23		
K16	2.6	1.6	1.3	2.6	1.6	4.2476	S
	1.04	3.2674		3.2674	1.04		
K17	2.0	1.2	1.0	2.0	1.2	1.8650	S
	0.60	1.6650		1.8650	0.60		
K18	2.8	2.3	3.2	2.8	2.3	16.1860	S
	1.61	5.0581		5.0581	1.61		
K19	3.0	0.7	2.2	3.0	1.5	5.9622	S
	0.53	1.6494		3.5344	1.15		
K20	3.8	2.0	2.0	2.350	3.8	12.9831	S
	1.90	5.9092		7.0438	2.23		
K21	2.35	2.5	1.8	2.3	2.4	8.0649	S
	1.47	4.6144		4.3355	1.38		
K22	2.3	1.7	2.150	2.3	1.7	6.0627	S
	0.98	3.0710		3.0710	0.98		
K23	0.8	2.3	2.9	0.8	2.3	4.1910	S
	0.48	1.4452		1.4452	0.48		
K24	2.6	4.1	1.3	2.6	4.1	10.8844	S
	0.67	8.3726		8.3726	2.67		
K25	2.6	4.1	2.0	2.6	4.1	16.7453	S
	0.67	8.3726		8.3726	2.67		
K26	1.75	1.9	14.2	2.9	2.4	57.3545	S log
	0.83	2.6115		5.4506	1.74		
K27	2.050	1.050	7.1	85	1.450	9.4383	S log
	0.54	1.6506		0.9080	0.31		
K28	1.4	1.8	7.7	2.7	2.4	27.2150	S log
	0.63	1.9793		5.0090	1.62		
K29	1.050	0.90	9.2	1.4	1.8	12.5189	S log
	0.24	0.7422		1.9793	0.63		
K30 dave	7	.7	8.4	1.8	1.8	12.3045	S log
	0.12	0.3849		2.5448	0.81		
K31 dave	0.75	0.8	6	1.5	1.4	6.3619	S log
	0.15	0.4713		1.6494	0.53		
K32	85	.55	2.7	95	1.5	2.0087	S log
	0.12	0.3672		1.1192	0.36		
K33	45	.7	8.9	1.4	1.6	8.9301	S log
	0.08	0.2474		1.7504	0.56		
K34	1.0	.6	9.5	1.6	1.9	13.5800	S log
	0.15	0.4713		2.3877	0.76		
K35	1.1	0.8	10	1.8	1.8	16.1708	S log ripple
	0.22	0.6912		2.5448	0.81		
K36	0.9	0.65	4.3	1.15	1.4	3.7066	S log
	0.15	0.4595		1.2645	0.40		
K37	1.6	1.3	1.6	2.5	3	6.0195	Stump dry
	0.52	1.6337		5.8907	1.68		
K38	0.6	0.6	8.2	1.05	1.05	4.7096	Dave
	0.09	0.2828		0.8658	0.28		
K39	0.6	1.55	9.2	2.7	1	13.1150	Dave
	0.23	0.7304		2.1206	0.68		
K40	0.9	0.85	5.2	1.3	1.3	5.0134	Dave
	0.10	0.6009		1.3274	0.42		
K41	0.5	0.95	8	1.9	1.4	9.8492	Dave
	0.12	0.3731		2.0892	0.67		